



Pump specifications:

Type.....BA200E D328
 Max. flow3300 US GPM (750 m³/hour)
 Max. pressure..... 177 ft. / 77 PSI (53 mwc)
 Connections..... Discharge 8"
 Connections..... Suction 10"
 Solids handling 3, 15" (80 mm)
 Impeller type Open impeller
 Priming system BBA MP50
 Engine John Deere 4045HF285
 Canopy EW12-25
 Weight (net) 5500 lb. (2500 kg)
 Sound level..... Approx. 75 dB(A) at 33 ft.

FEATURES

BA auto prime pump

The BA range of pumps have been designed with a clear focus on reliability, efficiency and durability. Featuring a fully automatic priming system, the BA series pumps quickly prime and re-prime, even from dry conditions. The heavy build style of both pump and canopy make the BA range perfect for use in the demanding construction market.

World-class performance

The BA range is built to be deployed on the most demanding applications. Using high efficiency pumps and state-of-the-art diesel engines, the pumps offer maximum performance at minimal cost, fully in-sync with the company philosophy of "Lowest cost of ownership".

Sustainability

- High efficiency pumps minimising fuel consumption
- Emissions according US EPA Tier regulations
- Corrosion free hot dip galvanised canopy
- Corrosion free composite door panels and powder coated plating
- 100% Oil-spill free priming system
- Fully self contained unit featuring a double wall fuel containment tank en fluid containment system eliminating fuel/oil spills at all times

Complete package designed & built by BBA Pumps

- Complete in-house design & production
- Over 60 years of experience in the market
- Extensive testing facility in-house
- Contemporary & functional design
- Durable & eco-friendly materials
- Custom builds available

After sales service & product support

- Single supplier for parts, spares & accessories
- Dedicated customer help-desk (24h service)
- Dedicated service department in-house
- Global parts distribution network
- Optional global on-site servicing
- Extensive training options available (technical & commercial), on-site or in-house



PERFORMANCE CURVES (2000 RPM)

Continuous duty according ISO 9906

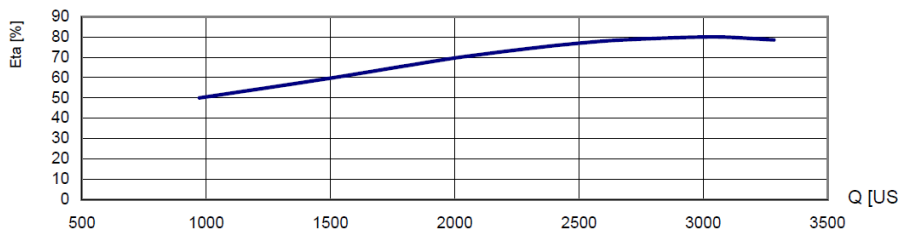
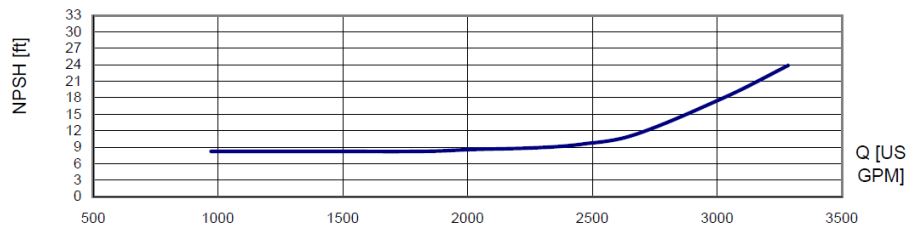
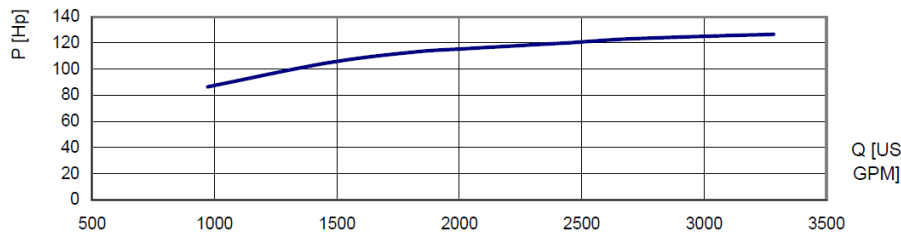
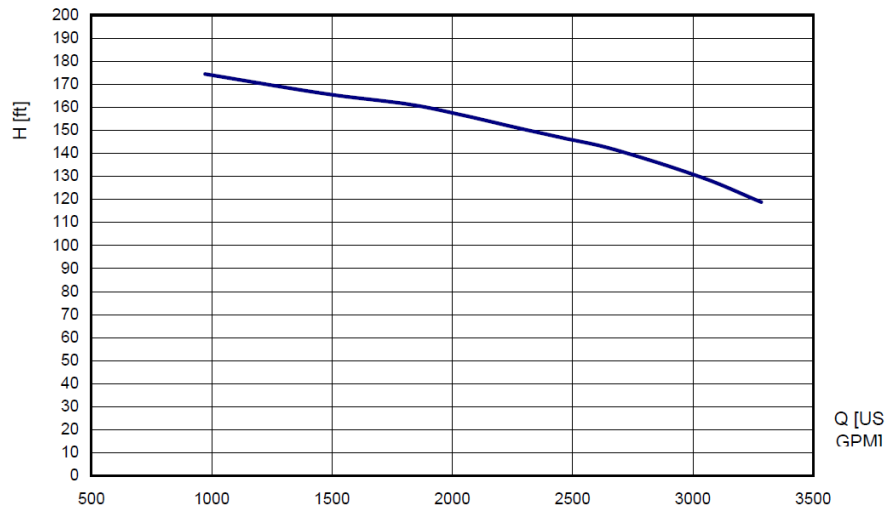

Engine speed rpm		Capacity Q US GPM					Fuel consumption (BEP)
		1320	1760	2200	2640	3080	GPH
2000	H	172	165	155	142	125	7
1800	Ft.	132	125	189	112	96	5,5
1500		89	83	76	66	53	3

STANDARD TECHNICAL SPECIFICATIONS

BBA auto prime pump

Pump type.....	BA200E D328
Max. flow.....	3300 US GPM (750 m ³ /hour)
Max. head.....	177 feet / 77 PSI (53 mwc)
Impeller type	Open impeller
Solids handling	3.15 inch (80 mm)
Pump casing.....	Cast iron GG20
Impeller	Chrome Moly 42CrM04
Wear plate	Chrome Moly 42CrM04
Pump shaft.....	C45
Shaft seal.....	Mechanical seal 2.36 inch (60mm)
Seal faces.....	Tung/Sic
Seal rubbers	Viton



BBA priming system

Pump type.....	BBA MP50 Diaphragm pump
Air handling capacity	30 CFM (50 m ³ /h)
Max. vacuum	25 inHg (8.5 m)
Drive	Toothed belt (continuous drive)
Float box	St 37 hot dip galvanised
Non return valve	Cast iron GG25
Check valve disc.....	Buna-N

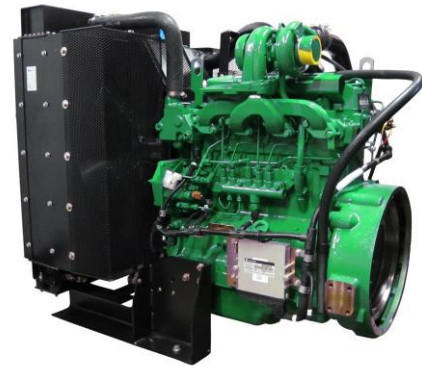

Engine

Engine brand	John Deere
Engine type.....	4045HF285
Flywheel power.....	143 Hp (105 kW)
Max. engine speed	2000 RPM
Fuel consumption	226 g/kWh
Displacement.....	4.5 l
Number of cylinders.....	4
Cooling system	Water cooled
Exhaust emission US	Tier 3

(Under Tier 3 Technical relief provision)

LOFA control panel

- Auto start/stop system
- Two float switches included (10m cable)
- Switch Manual-0-Auto
- Warning lights
- Safety features to protect the engine
- High resolution 4.3" LCD monitor



Fuel system

- PE fuel tank 80 US Gallon (300 L.) net
- Fuel tank cap Ø 2,5" (60 mm)
- Electronic fuel injection system
- Fitted with water separator & extra in-line fuel filter

Electrical system & safety features

- Premium quality battery 92 amp. 12 Volt
- Low oil pressure shut down
- High temperature shut down
- Overload shutdown

CANOPY EW12-25

BBA sound attenuating canopy

- Canopy type.....EW12-25
- Dimensions L x W x H98.4 x 49.2 x 78.6 inch
- Dimensions L x W x H2500 x 1250 x 1996 mm
- Basic frame.....Hot dip galvanised
- Panels.....ABS/ASA
- Doors4 Easy-access doors (lockable)
- Fuel tankPE net 80 US Gallon (300 ltr)
- Fuel tank autonomy11 hours (at 2000 rpm BEP)
- Fuel tank cap2.5 inch (60mm)
- Forklift pockets.....Fitted with 2 forklift pockets
- Lifting pointFitted with single lifting point
- Oil drain pumpDrain pump for motor oil installed (hand pump)
- Connections.....Please consult “auxiliary items” in overleaf
- Exhaust systemExhaust is mounted on roof canopy
- Radiator boxFitted with quick release system for easy cleaning
- Additional.....Fitted with oil-water separator



BBA E-slide® system

The EW12-25 canopy has been fitted with the BBA Eslide® system, meaning that the pump and the diesel engine are mounted on a sub-frame which can be removed quickly from the canopy. This facilitates cleaning of the canopy and also allows for quick and easy inspections and preventative maintenance work on the engine and pump should this be required.

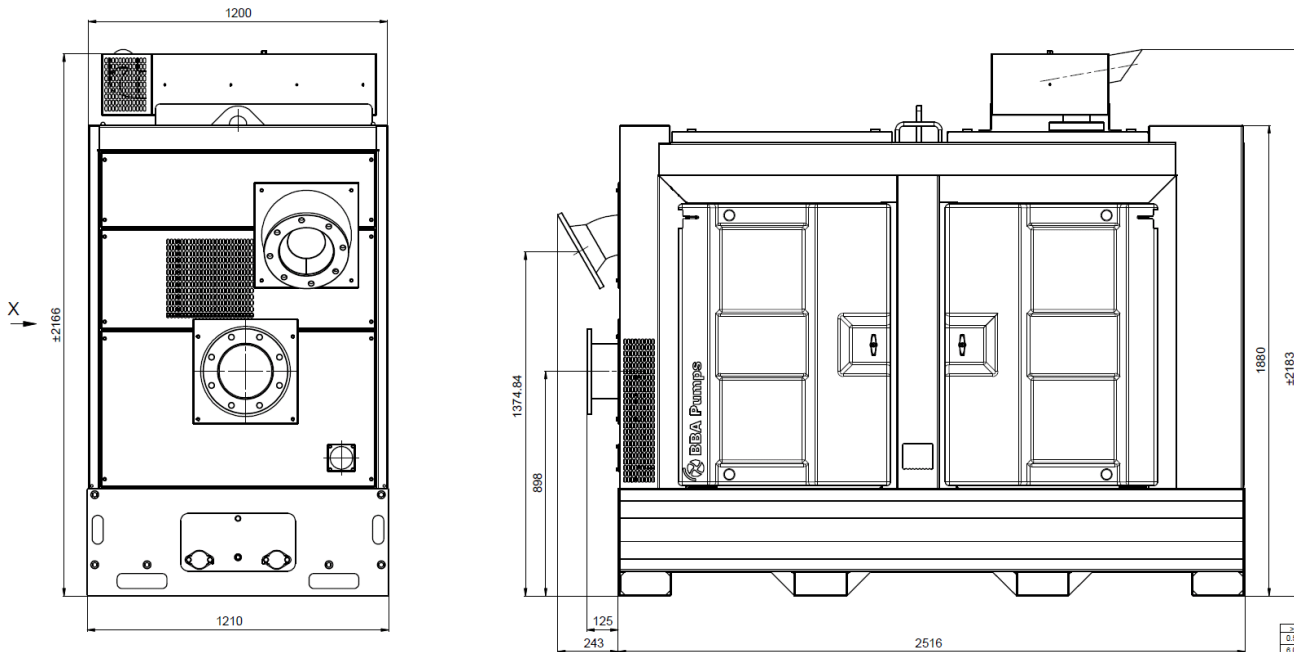

Actual dimensions (in mm) may vary depending on selected quick couplings.



Open impeller
Corrosion and abrasion resistant Chrome Moly (42CrM04) alloy.



Easy to clean canopy
The units are silenced without using sound-dampening materials, allowing the canopies to be cleaned quickly and thoroughly with a pressure washer.



Easy inspection
Oil glasses, drain valves and fill plugs all easily accessible.

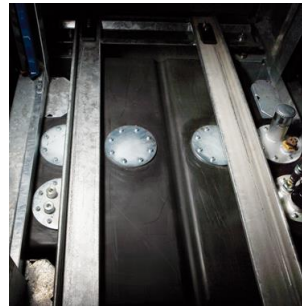

Fuel tank
Double wall fuel containment, corrosion-free, 80 US Gallon, high-density polyethylene (HDPE) fuel tank, located in base of canopy.



Large inspection covers
Easy access to float box, impeller and non-return valve.



Speedy servicing
The pump and diesel engine are mounted on a sub-frame which can be easily removed from the canopy to facilitate maintenance and servicing.



4 Year limited warranty
The BBA limited warranty covers years or operating hours whichever occurs first. For more details please consult the BBA warranty book.



Safety
Extremely durable and lockable T-locks offering perfect grip.

Pictures used are for illustration purposes only.

AUXILIARY ITEMS
Discharge connections

Art.nr.		Ø inch	Ø mm	Connection
1516604209	30° flange DIN	8	200	Flange
05080899	30° flange ANSI	8	200	Flange
05080813	30° female (cup)	8	200	system B
05080809	30° male (ball/lever)	8	200	system B
05080895	30° male (ball/ring)	8	200	system IT
05080898	30° female (cup/lever)	8	200	system IT

Suction connections

Art.nr.		Ø inch	Ø mm	Connection
17160295	0° flange K295 x K350	8-10	200-250	DIN Flange
03811500	0° male (ball/ring)	8	200	System IT
03811510	0° female (cup/lever)	8	200	System IT
03811505	0° male (ball/ring)	10	250	System IT
03811506	0° female (cup/lever)	10	250	System IT

Suction hose with strainer L=5 metre

Art.nr.	Ø inch	Ø mm	connection
07047042	8	200	System IT female (cup/lever)
07047057	8	200	Flange K295
07047062	10	250	Flange K350

Suction hose with strainer L=6 metre

Art.nr.	Ø inch	Ø mm	connection
07047043	8	200	System IT female (cup/lever)
07047058	8	200	Flange K295
07047063	10	250	Flange K350

Recommended suction pipe (maximum velocity = 4 m/sec)

US gallons	M3/H	FLOW (L/sec)	4" 100	5" 125	6" 150	8" 200	10" 250	12" 300
1426	324	90	11.46	7.33	5.09	2.86	1.83	1.27
1585	360	100	12.73	8.15	5.66	3.18	2.04	1.41
1775	403.2	112	14.26	9.13	6.34	3.57	2.28	1.58
1902	432	120	15.28	9.78	6.79	3.82	2.44	1.70
2060	468	130	16.55	10.59	7.36	4.14	2.65	1.84
2219	504	140	17.83	11.41	7.92	4.46	2.85	1.98
2337	540	150	19.10	12.22	8.49	4.77	3.06	2.12
2536	576	160	20.37	13.04	9.05	5.09	3.26	2.26
2694	612	170	21.65	13.85	9.62	5.41	3.46	2.41
2853	648	180	22.92	14.67	10.19	5.73	3.67	2.55
3011	684	190	24.19	15.48	10.75	6.05	3.87	2.69